



EMBASSY OF INDIA
545-547, Merchant Street,
Post Box No. 751
Yangon, Myanmar
Tel: (951) 391219, 243972, 388412
Fax: (951) 254086, 250164, 388414
Website: www.embassyofindiayangon.gov.in

No.YAN/ADM/885/04/2020

Dated: 7 May, 2021

Notice Inviting Tender

Subject: Supply and Installation of Security Systems (CCTV and Biometric Access System) at the Embassy Premises, Thilawa

The Embassy of India, Yangon invites Technical and Financial Bids from authorised dealers / contractors, reputed, experienced and financially sound companies, firms ("The Vendor") for supply, installation, commissioning of Closed Circuit Television (CCTV) Camera System and Biometric Access System along with other requisite accessories at Embassy Premises, Thilawa. The Cameras and biometric Access System will be installed as per the layout indicated at Annexure I.

2. The representatives of interested vendors may visit the site with prior appointment (Mr. Rohit Khatri, (Mob: +95-95418981) and submit their proposals / rate quotations.

3. Tender documents will be available on website <https://embassyofindiayangon.gov.in/> and www.eprocure.gov.in. Details can also be collected from SS (Administration), Tel: +95-01-251206 or admn.yangon@mea.gov.in.

Date of publishing NIT	:	7 May 2021
Date of site inspection	:	24 & 26 May 2021(10 AM to 5 PM)
Last date of submission of Tender	:	31 May 2021 (1200 hrs.)
Opening of Technical Bid	:	31 May 2021 (1600 hrs.)
Opening of Financial Bid	:	1 June 2021 (1100 hrs.)

4. Technical and Financial Bid must be submitted separately in two sealed envelopes clearly superscribed "TECHNICAL BID FOR SUPPLY AND INSTALLATION OF SECURITY SYSTEMS (CCTV AND BIOMETRIC ACCESS SYSTEM) CAMERAS AT THE EMBASSY PREMISES, THILAWA" and "FINANCIAL BID FOR SUPPLY AND INSTALLATION OF SUPPLY AND INSTALLATION OF SECURITY SYSTEMS (CCTV AND BIOMETRIC ACCESS SYSTEM) CAMERAS AT THE EMBASSY PREMISES, THILAWA" along with all relevant documents to the "Head of Chancery, Embassy of India, 545-547, Merchant Street, Yangon, Myanmar". Financial Bid submitted in a separate sealed envelope would be opened in respect of only those Bidders, whose Technical Bids have been found meeting the required

5. Earnest Money Deposit (EMD):

- (i) Each Technical Bid shall be accompanied by an Earnest Money Deposit (EMD) of USD 300 (US Dollar 300 only) in the form of a Bank Guarantee (BG) drawn on any Bank in favour of Embassy of India, Yangon or in cash deposited to Embassy.
- (ii) The Bank Guarantee should be valid for a minimum period of 180 days.
- (iii) The BG should be payable at Yangon only.
- (iv) EMD must be attached with Technical Bid only, without which the bid shall stand rejected.

Earnest money will be forfeited:

- (i) If the bidder withdraws his bid during the period of bid validity.
- (ii) In case of the successful bidder, if the bidder fails to sign the contract.

Refund of Earnest Money Deposit (EMD):

- (i) Refund of EMD to the unsuccessful bidders shall be made after signing of the contract with successful bidder.
- (ii) EMD of successful bidder shall be refunded after award of the contract and deposit of Performance Security @ 5% of the total contract value. Successful bidder will deposit Performance Security within 5 working days of award of contract. The Performance Security should be valid upto 60 days beyond the contract period. After successful completion of all contractual obligations, the Performance Security (without any interest) shall be refunded within 30 days.

6. The sealed envelope (Both Technical and Financial) should be submitted to the attention of the Head of Chancery, Embassy of India, Yangon latest by **31 May, 2021 (1200 hrs)** accompanied with the proof of payment of EMD.

7. The successful bidder shall be obliged to deposit an amount equivalent to 5% of the value of the contract to be awarded as performance guarantee. The performance guarantee shall remain valid for a period of 60 days beyond the completion of all contractual obligations of the bidder. The bid security shall be refunded to the successful bidder on the receipt of the performance guarantee.

8. Representatives of bidding companies can be present at the time of the opening of the bids. The bids shall be opened on **31 May 2021 at 1500 hrs** at the Embassy of India, Yangon, 545-547, Merchant Street, Yangon.

9. The Embassy of India, Yangon reserves the right to reject any or all the bids without assigning any reason. The decision of the Embassy shall be final and binding.

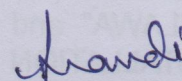

(Sankar Nandi)
Head of Chancery
Embassy of India, Yangon

Letter for Submission of Tender

Dated,

To:

The Head of Chancery,
Embassy of India,
545-547, Merchant Street,
Yangon, Myanmar

Ref: SUPPLY AND INSTALLATION OF SECURITY SYSTEMS (CCTV AND BIOMETRIC ACCESS SYSTEM) CAMERAS AT THE EMBASSY PREMISES, THILAWA

Dear Sir,

Having examined the tender document relating to the **Supply and Installation of Security Systems (CCTV and Biometric Access System) Cameras at the Embassy Premises, Thilawa**, we hereby submit our offer for the supply of the proposed items in accordance with terms and conditions and confirm our acceptance to execute the order within the time period specified in the tender document, at the rates quoted by us in the accompanying Technical & Financial Bid.

We further confirm that –

- i) We have successfully executed orders of similar nature and we have sufficient experience and financial strength in handling orders of this value.
- ii) We have sufficient qualified manpower and necessary materials and after sales support to execute the order efficiently in the specified time schedule.
- iii) The quoted rates shall be valid not less than 90 days from the date of opening of quotation.
- iv) We further confirm that all chapters of the tender documents have been read, understood and signed and there is no deviation/discrepancy.
- v) We agree to accept the extension order up to 100% quantity within three months of the issue of the order.

Signature of the Bidder With stamp and date

**EMBASSY OF INDIA
YANGON**

No. YAN/ADM/885/4/2020

Dated, 7 May, 2021

1.0 GENERAL

1.1. The CCTV and Biometric Access System shall be used to monitor cum record the movement of personnel around the office spaces at Thilawa and restrict the entry to office spaces only to authorized users. The vendor shall study the specifications and satisfy himself thoroughly and shall take full responsibility of the smooth, reliable and safe working. The representative of the vendor may visit the Embassy Premises, Thilawa (herein referred as 'the site') prior to placing its bids for satisfying himself for supply of requisite items essential for smooth functioning of the system. Site can be inspected between 10 AM to 5 PM on 24 & 26 May, 2021 with prior appointment. No transportation allowance or any other incidentals shall be payable by the Embassy to any out-station vendor on account of site visit. Technical and Financial Bid must be submitted separately in a sealed envelope clearly superscribed "TECHNICAL BID FOR SUPPLY AND INSTALLATION OF SECURITY SYSTEMS (CCTV AND BIOMETRIC ACCESS SYSTEM) CAMERAS AT THE EMBASSY PREMISES, THILAWA" and "FINANCIAL BID FOR SUPPLY AND INSTALLATION OF SECURITY SYSTEMS (CCTV AND BIOMETRIC ACCESS SYSTEM) CAMERAS AT THE EMBASSY PREMISES, THILAWA" along with all relevant documents to the "Head of Chancery, Embassy of India, 545-547, Merchant Street, Yangon, Myanmar". Financial Bid submitted in a separate sealed envelope would be opened in respect of only those Bidders, whose Technical Bids have been found meeting the required specifications at the Technical Bid evaluation stage. A bid sent through Fax or e-mail will not be acceptable in the quotation.

1.2 The project has to be implemented on a turn-key basis and therefore all items of instrument shall be completed in all respects and any instrument not covered in the specification but essential for proper installation, operation and maintenance of the instrument shall be included by the vendor in his offer and the reasons for such inclusion shall be clearly stated.

2.0 SCOPE OF WORK

2.1 The scope of work includes supply, installation and commissioning of **Security Systems (CCTV and Biometric Access System) Cameras at the Embassy Premises, Thilawa** in accordance with the design, specifications and layout given in "Annexure I Technical Bid A. TECHNICAL SPECIFICATIONS OF THE SECURITY SYSTEMS". In addition, the vendor will also undertake the maintenance of the complete system and supply of necessary spares.

2.2 Packaging, forwarding, transport, insurance, loading, unloading, precaution against damage during transit etc. is responsibility of the vendor.

2.3 Performance Guarantee to be submitted.

2.4 Two sets of operation and maintenance manuals to be provided.

2.5 Test Certificate: Vendor shall provide all necessary test certificates.

3.0 SAFETY

3.1 All equipment items shall be complete with approved safety devices, wherever a potential hazard to personnel exists, and with provision for safe access to personnel to and around the instrument for operational and maintenance functions.

4.0 TIME FOR COMPLETION

4.1 The vendor shall complete supply, installation and commissioning of the instrument within 2 months of placing the Purchase Order or the timeline specified by the Embassy.

5.0 TEST AND INSPECTION

5.1 Inspection of the equipment will be done at Embassy Premises, Thilawa.

5.2 The vendor shall demonstrate all the features of the equipment mentioned in the technical specification.

5.3 The vendor is solely responsible for installation, commissioning and making the complete system operational at user's site on a turn-key basis.

6.0 PREPARATION CONDITIONS

6.1 All equipment shall be designed for smooth, efficient and trouble-free operation in tropical humid climate of 45° C ambient and a humidity of 90% to 150%.

6.2 In cases where the offer deviates from the specification, the vendor shall indicate clearly in his offer the specification proposed by him along with details thereof and the reasons for the deviation. Each exception to the specification or other parts of the tender document shall be listed separately by the vendor. If exceptions are not clearly listed they will not be considered by the Purchaser later.

7.0 DOCUMENTS

7.1 The vendor shall supply the hard and soft copy of Operation and Maintenance manual in duplicate. All necessary literature giving complete technical details shall be provided. He should also provide the test certificates given by manufacturer.

7.2 The vendor shall provide the original DVD/CD of all the software used for operating the system.

8.0 INSTALLATION & COMMISSIONING

8.1 It is to be noted that supply, installation and commissioning of the system with all accessories, auxiliaries, and any item not covered in the specification but essential for proper installation, operation and maintenance of the CCTV System shall be included and executed by the vendor. The project has to be implemented on a turn-key basis.

8.2 The supply will not be deemed complete until the commissioning trial of the whole system is carried out by the vendor at the site successfully.

9.0 PERFORMANCE AND GUARANTEE (P. G.)

9.1 All necessary tests shall be carried out at the site by the vendor to demonstrate whether performance of the instrument conforms to the relevant standards and specifications and meets the functional requirement indicated in the specification.

10.0 WARRANTY

10.1 The warranty period for the equipment will commence from the date of commissioning of the entire system and not from the date of delivery or installation.

10.2 The vendor shall provide warranty for the entire system for a minimum period of 12 months from the date of commissioning or for the duration of OEM warranty period whichever is longer.

10.3 The time period for product warranty will be the same as the service warranty.

10.4 The vendor shall be responsible for routine and breakdown maintenance of the equipment during warranty period of 12 months.

10.5 The vendor shall also provide an Annual Maintenance Contract (AMC) till 31 Oct 2026, commencing after the expiry of the initial product/service warranty, for maintaining the installed system and provide a dedicated on-call technician.

10.6 The AMC should include two (2) periodic maintenance service visit, in addition to site visit for repairing faults on detection as and when required.

11.0 SERVICE AGREEMENT

11.1 The selected vendor shall have to sign a Non-Disclosure Agreement (NDA) on the service to be provided.

12.0 PAYMENT TERMS

12.1 The payment will be released in full only after receipt, satisfactory installation/commissioning of the equipment in question and in good condition in the Embassy.

13.0 CAPABILITY AND EXPERIENCE

13.1 The vendor shall have executed at least two (2) similar kind of work within last 3 years. The vendor shall submit along the offer the reference list of the similar work. Offers received without the reference list may be rejected.

14.0 TRAINING

14.1 Vendor shall provide necessary on-site training about the working of the Security System and the relevant software.

15.0 QUOTATION

15.1 Interested vendors should submit Technical Bid and Financial Bid separately in a sealed envelop clearly superscribed "TECHNICAL BID FOR SUPPLY AND INSTALLATION OF SECURITY SYSTEMS (CCTV AND BIOMETRIC ACCESS SYSTEM) CAMERAS AT EMBASSY PREMISES, THILAWA" and "FINANCIAL BID FOR SUPPLY AND INSTALLATION OF SECURITY SYSTEMS (CCTV AND BIOMETRIC ACCESS SYSTEM) CAMERAS AT EMBASSY PREMISES, THILAWA" along with all relevant documents within the specified date and time. A bid sent through Fax or e-mail will not be accepted.

15.2 Vendor can submit quotation in US Dollar. The total rate quoted shall be inclusive of Tax.

16.0 CLARIFICATIONS

16.1 For any clarification and appointment for site visit, the vendor may contact the Embassy by e-mail (hoc.yangon@mea.gov.in / adm.yangon@mea.gov.in) and Tel: 95-1-391219 and Fax: 95-1-254086

17.0 LAST DATE OF RECEIPT OF TENDER

17.1 Tender will not be accepted if they are received after the due date and time as specified in the quotations letter i.e. on **31 May 2021**

17.2 The vendor shall be required to submit the complete layout plan in connection with tender before executing the work

18.0 OPENING DATE OF TENDER

18.1 The tender will be opened on **31 May 2021** in the Embassy. The Technical Bids (Annexure I) will first be evaluated and only vendors who qualified in the Technical Bids will only be considered for further evaluation of Financial Bids (Annexure II).

19.0 EMBASSY OF INDIA, YANGON RESERVES THE RIGHT

19.1 The right of acceptance of tender(s) will rest with Competent Authority. Also, the Embassy is not bound to accept the lowest tender and reserves the right to reject or partially accept any or all the tender(s) received without assigning any reasons thereof.

TECHNICAL BID**A. TECHNICAL SPECIFICATIONS OF THE SECURITY SYSTEM**

DEVICE/ EQUIPMENT	PARTICULARS	MAKE	QTY
IP CCTV Camera*	2 to 4 MP Dome Varifocal High Speed IP PTZ Waterproof Equipped with IR LED Night mode / IR for all cameras	Bosch/ Honeywell/ Pelco/ Panasonic/ Sony/ Samsung	01
IP CCTV Camera*	2 to 4 MP Bullet Varifocal High Speed IP PTZ Waterproof Equipped with IR LED Night mode / IR for all cameras	Bosch/ Honeywell/ Pelco/ Panasonic/ Sony/ Samsung	04
Network Video Recorder *	8 Channel, third-party network cameras supported, up to 5 Megapixels resolution recording, HDD quota and group management	Bosch/ Honeywell/ Pelco/ Panasonic/ Sony/ Samsung	01
Surveillance-Optimised Storage	2 TB HDD	Seagate, WD, LG	01
POE Switch	8 GE + 2 SFP port	Cisco/HP/ Alcatel-Lucent/ Any reputed brand	01
Monitor	32" LED / LCD monitor, 4k display, HDMI, USB 3.0, Ethernet and with wall mounting arrangement and suitable voltage stabilizer along with wall mounting bracket	Any reputed brand	01
CAT 6a UTP Cable, Server Cabinet + Accessories	Enhanced performance cable for transmission of high speed data, digital and analogue voice and video (RGB) signals on LANs, 12/17/42U Server Cabinet & shelf, 16A 6 ways PDU with Universal Input Plug	Reputed brand	On actuals
Biometric Access System	Main Console with provision for finger print reader and key pad along with associated power adapter, cables and door holding / fixing mechanism / EM lock with supply and installation of a switch inside room for remote opening	Reputed brand	02

PVC Conduit, Trunking + Accessories	Adaptable to standard concealed wiring system as per IS: & BS: Virgin Suspension grade K-67 PVC.	Reputed brand	On actuals
2 KVA UPS	With rack and associated cabling for back up supply to CCTV System and Biometric Access System	Reputed brand	01
All-inclusive AMC	From the dates of expiry of warranty till 31 Oct 2026		
Installation and User training	Supply, installation, testing, configuration and commissioning of complete set up of CCTV System, Biometric Access System and UPS Manual Labour work for all associated installation, cabling and conduits works Supply and installation of all equipment including all accessories (cables, mounting arrangement, clamps, brackets etc.) required for installation as per the proposed layout		
Other Requirements	One year warranty / guarantee for all equipment Delivery and unpacking at Thilawa		

Recording facility to store and transfer upto 30 days of recording

* **Important** : Network Video Recorder should be of same company as that of camera. Cameras should be ULCAP (Cybersecurity Assurances Programme) compliant.

B. MATRIX FOR TECHNICAL SPECIFICATIONS

Ser	Product Description	Unit	Qty	Whether the Company would be able to provide the given Specifications and Quantity (Yes/ No)	If not, the nearest Specifications that the Company can provide	Remarks
(1)	(2)	(3)	(4)	(5)	(6)	(7)
1	Supply, Installation, Testing & Commissioning of High Speed IP Full HD PTZ Dome 1/1.8" or better CMOS Sensor, 2-4 MP Resolution, MJMEG/JPEG	Nos	01			

Ser	Product Description	Unit	Qty	Whether the Company would be able to provide the given Specifications and Quantity (Yes/ No)	If not, the nearest Specifications that the Company can provide	Remarks
(1)	(2)	(3)	(4)	(5)	(6)	(7)
	Baseline Encoding True Day/Night Network Switching IP, H.265 Dome Camera with external/internal IR with 1/3" or 1/2.7" or better Progressive Scan. The cameras shall have a minimum illumination of 0.008 Lux @50 IRE in colour mode, 0.001 Lux@50 IRE in Black & White mode and 0 Lux with external IR along with weather protected features. (Camera Should be - UL Listed)					
1	Supply, Installation, Testing & Commissioning of Fixed IP PTZ Varifocal High Speed 2-4 MP Bullet Camera with 1/3" Progressive Scan CMOS Sensor, 0.008 Lux @ F1.2 Illumination with IR, Super WDR up to 120 db, 1920x1080 image resolution, H.265(HEVC)/H.264 /MJPEG Video Compression along with weather protected features. Equipped with IR LED. Night mode / IR (Camera Should be – UL Listed)	Nos	04			
2	Supply, Installation, Testing & Commissioning of High Speed 08 CH NVR Video Output HDMI (1440x900 to 1920x1080) VGA (1440x900 to 1920x1080) CVBS (1440x900 to 1920x1080), Audio Input & Output supported, H.264 Video Compression, Audio Compression G711U, 4 SATA.	Nos	01			
3	Supply, Installation, Testing & Commissioning of Surveillance-Optimised storage of 2TB capacity HDD	Nos	01			
4	Supply, Installation, Testing & Commissioning of 32" LED / LCD monitor, 4k display, HDMI, USB 3.0, Ethernet and with wall mounting arrangement and suitable voltage stabilizer along with wall mounting bracket	Nos	1			
5	Supply, Installation, Testing & Commissioning of suitable U (12/17/42U)	Nos	1			

Ser	Product Description	Unit	Qty	Whether the Company would be able to provide the given Specifications and Quantity (Yes/ No)	If not, the nearest Specifications that the Company can provide	Remarks
(1)	(2)	(3)	(4)	(5)	(6)	(7)
	Rack for Switch Mounting with Fan and Power Strip, PoU, Hardware Mounting Kit.					
6	Supply, Installation, Testing & Commissioning of suitable Outdoor Industrial Rack for Switch Mounting with Fan and Power Strip, PoU, Hardware Mounting Kit.	Nos	1			
7	Supply, Installation, Testing & Commissioning of 8 GE + 2 SFP Port PoE Switch, PoE Port Output Power 15.4w/30w//IEEE802.3af/at, Protocol Standard IEEE802.3af/IEEE802.3at, Forwarding Rate 100 Mbps: 14880pps /1000 Mbps:14800pps.	Nos	1			
8	Supply, Installation, Testing & Commissioning of fully loaded 8/ 24 Port Patch Panel available in 1U 24 Port Density. Jack should be covered for prevention from dust and other contaminants. Flat type metal with perforated Rear Cable Manager to hold Cables with Velcro or Cable Ties. RoHS Compliant.	Nos	01			
9	Supply, Installation, Testing & Commissioning of LC-LC Single Mode, 3 mtr Fiber Patch Cord in L.SOH Jacket, which reduces toxic/corrosive gases emitted during combustion.	Mtr	As required			
10	Supply, Installation, Testing & Commissioning of Category 6A Field Termination Plug designed to support 10 GB Networks that can be easily terminated using parallel Jaw Pliers.	Nos.	01			
11	Supply, Installation, Testing & Commissioning of Biometric Access System Main consisting of Main Console with provision for finger print reader and key pad along with associated power adapter, cables and door holding /	Nos.	02			

Ser	Product Description	Unit	Qty	Whether the Company would be able to provide the given Specifications and Quantity (Yes/ No)	If not, the nearest Specifications that the Company can provide	Remarks
(1)	(2)	(3)	(4)	(5)	(6)	(7)
	fixing mechanism / EM lock with supply and installation of a switch inside room for remote opening including laying out of all cables, conduit, power socket, labour and accessories required					
12	Supply, Installation, Testing & Commissioning of 2 KVA UPS with rack and associated cabling for back up supply to CCTV System and Biometric Access System including laying out of all cables, conduit, power socket, labour and accessories required	Nos.	01			
13	Supplying and Drawing 3x 1.5 sq mm sizes of PVC insulated Copper Conductor, Single Core Cable in the existing surface/ recessed steel/ PVC Conduit as required.	Mtr	As required			
14	Supplying and Fixing of 25 sizes of medium class PVC Conduit alongwith accessories in surface/recess including cutting the wall and making good the same in case of recessed conduit as required.	Mtr	As required			
15	Supply & Laying of standardized 40 mm HDPE Pipe (Medium) inside the soft soil in depth of approx. 75 cm including Bends, Inspection Box and all other material required to complete.	Mtr	As required			
16	Pole 5/9 meter Galvanized Pole	Nos.	As required			
17	Trenching	Mtr	As required			
18	Junction Box	Nos	As required			
19	Annual Maintenance Contract (Till 31 Oct 2026 from the date of completion of warranty period)					
20	Any other Material/Equipment/ accessories		As			

Ser	Product Description	Unit	Qty	Whether the Company would be able to provide the given Specifications and Quantity (Yes/ No)	If not, the nearest Specifications that the Company can provide	Remarks
(1)	(2)	(3)	(4)	(5)	(6)	(7)
	and Specification thereof		required			
(a)						
(b)						
(c)						
(d)						
21	Installation and User training includes supply, installation, testing, configuration and commissioning of complete set up of CCTV System, Biometric Access System and UPS. Manual Labour work for all associated installation, cabling and conduits works. Supply and installation of all equipment including all accessories (cables, mounting arrangement, clamps, brackets etc.) required for installation as per the proposed layout					
22	Other Requirements One year warranty/ guarantee for all equipment Delivery and unpacking at Thilawa					

TOP VIEW

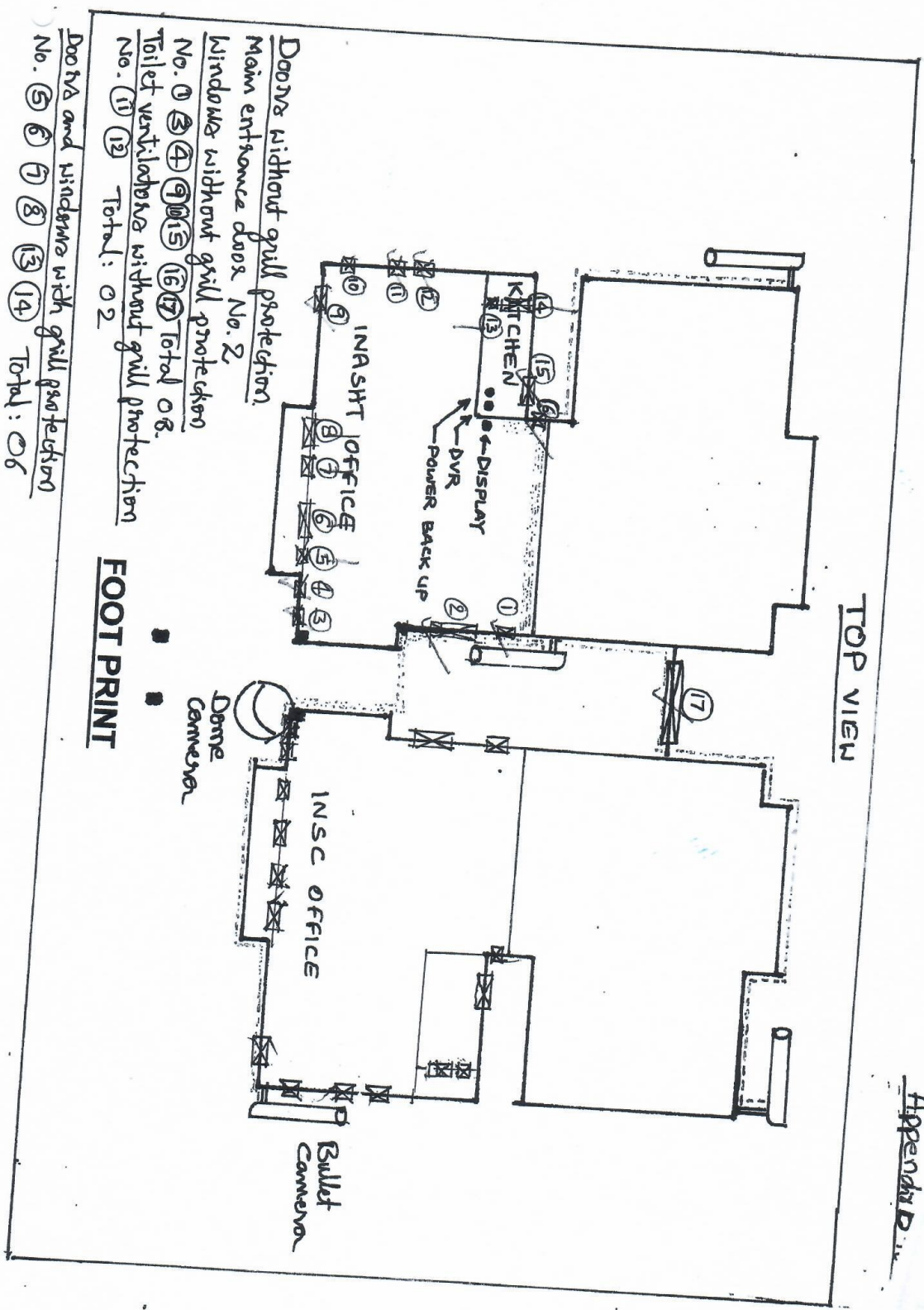

FOOT PRINT

Doors without grill protection.
Main entrance doors. No. 2

Windows without grill protection
No. ① ② ③ ④ ⑨ ⑩ ⑮ ⑯ ⑰ Total 08.

Toilet ventilators without grill protection
No. ⑪ ⑫ Total: 02

Doors and windows with grill protection
No. ⑤ ⑥ ⑦ ⑧ ⑬ ⑭ Total: 06

C. GENERAL INFORMATION

1	Name and Address of the Bidder	
2	Contacts	
3	Telephones	
4	Mobile no.	
5	Fax	
6	E-mail	
7	Category of the Bidder (Whether company, partnership firm or Proprietary concern)	
8	Name of Chief Executive Officer and Telephone no.	
9	Year of Establishment (Submit proof of Company Registration)	
10	Name and address of the Banker	
11	List of major Clients and the size of orders executed (Submit proof)	
12	Whether EMD is submitted	

Note: Separate sheets may be attached wherever necessary.

It is hereby certified that M/s..... (Name of the Company) is capable of providing and undertakes to provide above "Specifications and Quantity" at the time of supply, installation, testing and commissioning of the Security Systems.

(Seal & Signature of the authorised Company Representative)
Name & Address

D. DESIRED SPECIFICATIONS FOR THE PROPOSED CCTV CAMERAS

2-4 Megapixel H.265 Vandal Proof Network Dome IR Camera		
KEY FEATURES		
<ul style="list-style-type: none"> - 0.008 Lux - H.265 High Efficiency Video Coding - Integrated Motorized Varifocal Lens (Auto focus) - Built-in ICR Filter for Day/Night switching - Built-in web server for IE/Firefox/Chrome/Safari preview - 3D-DNR, Privacy Masking and Motion Detection - Built-In efficient IR LEDs, IR distance up to 30m - Weather-proof IP-67 rated housing - Built-in 802.3af Compliant PoE - Support ONVIF Profile S 		
IP VIDEO SURVEILLANCE SOLUTION		
	DESCRIPTION	SPECIFICATIONS
CAMERA	Image Sensor	1/3" Progressive Scan CMOS
	Min. Illumination	Color: 0.008Lux@F1.2 , B/W: 0Lux with IR on
	WDR	Super WDR up to 120dB
	Supply, Installation, Testing & Commissioning of Surveillance-Optimised storage of 4TB capacity HDDLens	3.6mm
	Field of View	H78.4°~H26.2° (2.8~12mm)
	Shutter Time	1/100000s~1/5s
	IR Distance	Up to 30m
	Day & Night	ICR Filter Auto Switch
	Max Image Resolution	1920X1080
	VIDEO	Frame Rate
Video Compression		H.265(HEVC) / H.264 / MJPEG
Video Bit Rate		160Kbps~16Mbps(CBR/VBR Adjustable)
Image Setting		Brightness/Contrast/Saturation/Sharpness
NETWORK	Ethernet	1*RJ45 10M / 100M Ethernet Port
	Network Storage	NAS(Support NFS, SMB/CIFS)
	Protocol	TCP/IP, UDP, RTP, RTSP, HTTP, HTTPS, DNS, DDNS, DHCP, FTP, NTP, SMTP, SNMP, UPNP, SIP, IPv6, PPPoE, VLAN
AUDIO	Audio Streaming	Built-in Microphone
	Audio Compression	G.711 and AAC

SYSTEM	Advanced Function	Motion Detection, Privacy Masking, Backlight Compensation, 3D-DNR, ROI
	SIP/VoIP Support	Yes, Voice & Video over IP
	Event Trigger	Motion Detection, Network Disconnection, etc.
	Event Action	FTP Upload/SMTP Upload/SIP Phone
	System Compatibility	ONVIF Profile S
GENERAL	Power Supply	PoE
	Power Consumption	2.5W MAX, 5.5W MAX (With IR on) {can be removed}
	Weather Proof	Up to IP67 Rating for Weather-resistant
	Certification	CE, FCC, Rohs

NETWORK BULLET IR CAMERA (FIXED)		
KEY FEATURES		
	DESCRIPTION	SPECIFICATIONS
CAMERA	Image Sensor	1/3" Progressive Scan CMOS
	Min. Illumination	Color: 0.008Lux@F1.2 , B/W: 0Lux with IR on
	WDR	Super WDR up to 120dB
	Lens	3.6mm
	Field of View	H78.4°~H26.2° (2.8~12mm)
	Shutter Time	1/100000s~1/5s
	IR Distance	Up to 30m
	Day & Night	ICR Filter Auto Switch
	Max Image Resolution	1920X1080
VIDEO	Frame Rate	20fps(2592x1520) 25fps(2304x1296) 25fps(1920x1080)
	Video Compression	H.265(HEVC) / H.264 / MJPEG
	Video Bit Rate	160Kbps~16Mbps(CBR/VBR Adjustable)
	Image Setting	Brightness/Contrast/Saturation/Sharpness
NETWORK	Ethernet	1*RJ45 10M / 100M Ethernet Port
	Network Storage	NAS(Support NFS, SMB/CIFS)
	Protocol	TCP/IP, UDP, RTP, RTSP, HTTP, HTTPS, DNS, DDNS, DHCP, FTP, NTP, SMTP, SNMP, UPNP, SIP, IPv6, PPPoE, VLAN
AUDIO	Audio Streaming	N/A
	Audio Compression	N/A
SYSTEM	Advanced Function	Motion Detection, Privacy Masking, Backlight Compensation, 3D- DNR, ROI
	SIP/VoIP Support	Yes, Voice & Video over IP
	Event Trigger	Motion Detection, Network Disconnection, etc.

	Event Action	FTP Upload/SMTP Upload/SIP Phone
	System Compatibility	ONVIF Profile S
GENERAL	Power Supply	PoE
	Power Consumption	5.5W MAX, 9.5W MAX (With IR on) {can be removed}
	Weather Proof	Up to IP67 Rating for Weather-resistant
	Certification	CE, FCC, Rohs
NETWORK BULLET IR CAMERA (MOTORIZED)		
KEY FEATURES		
<ul style="list-style-type: none"> - 0.008 Lux - Super WDR up to 140 dB - H.265 High Efficiency Video Coding - Integrated Motorized Varifocal Lens (Auto focus) - Built-in ICR Filter for Day/Night switching - Built-in web server for IE/Firefox/Chrome/Safari preview - 3D-DNR, Privacy Masking and Motion Detection - Built-In efficient IR LEDs, IR distance up to 30m - Weather-proof IP-67 rated housing - Built-in 802.3af Compliant PoE - Support ONVIF Profile S 		
IP VIDEO SURVEILLANCE SOLUTION		
	DESCRIPTION	SPECIFICATIONS
CAMERA	Image Sensor	1/3" Progressive Scan CMOS
	Min. Illumination	Color: 0.008Lux@1.2 , B/W: 0Lux with IR on
	WDR	Super WDR up to 120dB
	Lens	Motorized 2.8 ~ 12mm
	Field of View	H78.4°~H26.2° (2.8~12mm)
	Shutter Time	1/100000s~1/5s
	IR Distance	Up to 30m
	Day & Night	ICR Filter Auto Switch
	Max Image Resolution	1920x1080
VIDEO	Frame Rate	20fps(2592x1520) 25fps(2304x1296) 25fps(1920x1080)
	Video Compression	H.265(HEVC) / H.264 / MJPEG
	Video Bit Rate	160Kbps~16Mbps(CBR/VBR Adjustable)
	Image Setting	Brightness/Contrast/Saturation/Sharpness
NETWORK	Ethernet	1*RJ45 10M / 100M Ethernet Port
	Network Storage	NAS(Support NFS, SMB/CIFS)
	Protocol	TCP/IP, UDP, RTP, RTSP, HTTP, HTTPS,DNS,DDNS, DHCP, FTP, NTP, SMTP, SNMP, UPNP, SIP, IPv6, PPPoE, VLAN

AUDIO	Audio Streaming	N/A
	Audio Compression	N/A
SYSTEM		
	Advanced Function	Motion Detection, Privacy Masking, Backlight Compensation, 3D-DNR, ROI
	SIP/VoIP Support	Yes, Voice & Video over IP
	Event Trigger	Motion Detection, Network Disconnection, etc.
	Event Action	FTP Upload/SMTP Upload/SIP Phone
	System Compatibility	ONVIF Profile S
	Power Supply	PoE
	Power Consumption	5.5W MAX, 9.5W MAX (With IR on) {can be removed}
GENERAL	Weather Proof	Up to IP67 Rating for Weather-resistant
	Certification	CE, FCC, Rohs

High Speed full HD PTZ Dome (36X) Camera		
KEY FEATURES - 2-4 MP Resolution - 36x Optical Zoom - 5-120 mm Focal Length - 255 Preset Position - 360 Continuous Rotation - 8 Cruise Track - 4 Pattern Track		
Sl.No	Description	Specification
1.	Signal model	PAL / NTSC
2.	Image Sensor	1/1.8" or better CMOS
3.	Effective pixel	2084(H)* 1536(V)
4.	Horizontal Resolution	2-3 MP
5.	Minimum Illumination	Colour-0.01 lux / B&W - 0.001 Lux
6.	S/N ratio	>60dB
7.	Backlight compensation	On/Off
8.	White balance	Auto
9.	Electronic shutter	PAL:1/25~1/100000s NTSC:1/30~1/100000s
10.	Focus length	5-120mm
11.	Optical focus	36x
12.	Focus system	Auto/Manual
13.	IR distance	150M
14.	IR light control	Intelligent control technology
15.	IR light angle	Infrared zoom matching technology
16.	IR light power	Auto setting

CAMERA

17.	IR on	Day/Night/Auto/Timing	SYSTEM
18.	IR Life	30000 hours	
19.	Horizontal range	360° Continuous rotation	
20.	Vertical range	(-90°~0°)	
21.	Preset call speed	Max 200°/S	
22.	Manual call speed	0.01°~180°/S	
23.	Presets	255	
24.	Cruise track	8 groups, each group for 16 presets	
25.	Patrol tract	4 groups, each group record 3 mins	
26.	Video compression	H.265 Main Profile encoding ; MJPEG /JPEG Baseline encoding	
27.	Audio compression	G.711, G.726	
28.	Primary stream	2048*1536 25fps	
29.	Secondary stream	720P, VGA 25fps	
30.	Video bit rate	32 Kbps-16Mbps continuously adjustable, support CBR / VBR	
31.	Alarm Input / Output	Yes 1/1	
32.	Network protocol	TCP/IP, UDP, RTP, RTSP, RTCP, HTTP, DNS, DDNS, DHCP, FTP, PPPOE, SMTP, UPNP	
33.	ONVIF support	Support	GENERAL
34.	Cooling Structure	Dust proof structure outside the circle	
35.	Protection level	IP66	
36.	Power supply / PoE	DC12V(4A)/POE Supported	
37.	Certification	CE, FCC, RoHS	

Other Technical Specifications

8 CH NVR (4HDD)		
KEY FEATURES		
- P2P cloud service, including cloud connecting, cloud monitoring, cloud transmitting to access IPC and NVR at any time and any place.		
- Support Onvif protocol, support High profile S, High profile G, compatible with different IP camera that based on Onvif, RTSP standard.		
- Support for H.264+ encoding format streaming access and decoding output		
- Support megapixel HD network video preview, storage and playback		
- Support search, playback and backup by event		
- Support all channel image display on one screen at same time, support 4 channels' image display by mainstream and 4 channels playback		
- Support monitor PTZ on preview mode		
S. No	DESCRIPTION	SPECIFICATION
1	Operation System	Embedded LINUX system
2.	Dual Stream	Channel can set main stream and sub stream

3.	Video Standard	H.264+/H.264
4.	Monitoring Image Quality Supply, Installation, Testing & Commissioning of Surveillance- Optimised storage of 4TB capacity HDD	4K / 5MP / 3MP / 2MP / 1.3MP / 1MP
5.	Image Motion Image	Each screen can set multiple detection areas and set 6-level sensitivity
6.	Recording Playback Quality	Any 4ch 8MP playback/9ch 5MP playback/16ch 2 MP playback simultaneously
7.	Recording Mode	Support manual, auto, dynamic detection, alarm trigger record mode
8.	Backup Way	Support U disk, USB mobile HDD, USB DVDRW, network storage and backup (Partly needs IPC Support)
9.	Operation Way	Mouse, Keyboard
10.	Local Login	Username and password
11.	Recording Storage	Local HDD, network
12.	Video Input (mode)	1) 32x(3840*2160)+sub[960*576]+4Ref.+4Play H.264+8M/ch 32ch 4K IP Camera 2) 32x(2592*1944)+sub[960*576]+4Ref.+9Play H.264+8M/ch 32ch 5MP IP Camera 3)32x(1920*1080)+sub[960*576]+4Ref.+16Play H.264+4M/ch 32ch 2MP IP Camera
13.	Audio Input	32ch network audio input
14.	Video Output	1ch VGA+1ch HDMI
15.	Audio Port	1ch RCA output
16.	Network Port	1 RJ45, 10M/100M/1000M self-adaptive LAN
17.	RS485 Port	Full duplex standard 485 port
18.	USB Port	1USB 3.0 Port, 2 USB 2.0 ports
19.	Alarm Input / Output	4ch / 4ch
20.	HDD Port	4xSATA+1xE-SATAHDD Port
21.	Max Capacity	Each Port supports MAX 6 TB HDD
22.	Mobile Surveillance	Supported
23.	Certification	CE, FCC, RoHS

DATA SHEET FOR 8 GE + 2 SFP PORT POE SWITCH

Sl. No.	DESCRIPTION	SPECIFICATION
1	PoE Port	16*10/100/1000 port support IEEE802.3af/at
2	SFP port	Yes
3	PoE port output power	15.4W/30W IEEE802.3af/at
4	PoE power supply pins	Both 1/2+, 3/6- and 4/5+, 7/8-
5	Transmission distance	100 ~ 150m
6	Protocol standard	IEEE802.3af/IEEE802.3at
7	PoE type	End-span
8	Network standard	IEEE 802.3, IEEE802.3u, 802.3x, 802.3af/at
9	Network medium	10/100/1000Mbps 5 class and above non shielded twisted pair
10	Network Signal Distance	<150m
11	Switch capability	7.2Gbps
12	Forwarding Mode	Store and forward
13	Forwarding Rate	100Mbps:14880pps / 1000Mbps:14800pps
14	MAC Address	MAC address table 8K
15	Port function	Power priority mechanism, fast and forward, MAC IEEE802.3X Full-duplex and mode and backpressure for Half-duplex mode
16	Indicator	Each port occupied 1 LINK/ACT.100Mbps POE Status Indicator, Whole power indicator
17	Working Temperature	-10° ~ 55° C
18	Input power	AC100-240V 50/60HZ
19	Whole power	250W

Annexure II

A. MATRIX FOR FINANCIAL BID

Ser	Product Description	Unit	Qty	Warranty (Months)	Rate per Unit	Total Cost (Rate x Qty) (US\$/MMK)
(1)	(2)	(3)	(4)	(5)	(6)	(7)
1	Supply, Installation, Testing & Commissioning of Fixed IP PTZ Varifocal High Speed 2-4 MP Bullet Camera with 1/3" Progressive Scan CMOS Sensor, 0.008 Lux @ F1.2 Illumination with IR, Super WDR up to 120 db, 1920x1080 image resolution, H.265(HEVC)/H.264 /MJPEG Video Compression along with weather protected features. Equipped with IR LED. Night mode / IR (Camera Should be – UL Listed)	Nos	04			
2	Supply, Installation, Testing & Commissioning of High Speed 08 CH NVR Video Output HDMI (1440x900 to 1920x1080) VGA (1440x900 to 1920x1080) CVBS (1440x900 to 1920x1080), Audio Input & Output supported, H.264 Video Compression, Audio Compression G711U, 4 SATA.	Nos	01			
3	Supply, Installation, Testing & Commissioning of Surveillance-Optimised storage of 2TB capacity HDD	Nos	01			
4	Supply, Installation, Testing & Commissioning of 32" LED / LCD monitor, 4k display, HDMI, USB 3.0, Ethernet and with wall mounting arrangement and suitable voltage stabilizer along with wall mounting bracket	Nos	1			
5	Supply, Installation, Testing & Commissioning of suitable U (12/17/42U) Rack for Switch Mounting with Fan and Power Strip, PoU, Hardware Mounting Kit.	Nos	1			
6	Supply, Installation, Testing & Commissioning of suitable Outdoor Industrial Rack for Switch Mounting with Fan and Power Strip, PoU, Hardware Mounting Kit.	Nos	1			
7	Supply, Installation, Testing & Commissioning of 8 GE + 2 SFP Port PoE Switch, PoE Port Output Power 15.4w/30w/IEEE802.3af/at, Protocol Standard IEEE802.3af/IEEE802.3at, Forwarding Rate 100 Mbps: 14880pps /1000 Mbps:14800pps.	Nos	1			
8	Supply, Installation, Testing & Commissioning of	Nos	01			

Ser	Product Description	Unit	Qty	Warranty (Months)	Rate per Unit	Total Cost (Rate x Qty) (US\$/MMK)
(1)	(2)	(3)	(4)	(5)	(6)	(7)
	fully loaded 8/ 24 Port Patch Panel available in 1U 24 Port Density. Jack should be covered for prevention from dust and other contaminants. Flat type metal with perforated Rear Cable Manager to hold Cables with Velcro or Cable Ties. RoHS Compliant.					
	Supply, Installation, Testing & Commissioning of LC-LC Single Mode, 3 mtr Fiber Patch Cord in L.SOH Jacket, which reduces toxic/corrosive gases emitted during combustion.	Mtr	As required			
9	Supply, Installation, Testing & Commissioning of Category 6A Field Termination Plug designed to support 10 GB Networks that can be easily terminated using parallel Jaw Pliers.	Nos.	01			
10	Supply, Installation, Testing & Commissioning of Biometric Access System Main consisting of Main Console with provision for finger print reader and key pad along with associated power adapter, cables and door holding / fixing mechanism / EM lock with supply and installation of a switch inside room for remote opening including laying out of all cables, conduit, power socket, labour and accessories required	Nos.	02			
11	Supply, Installation, Testing & Commissioning of 2 KVA UPS with rack and associated cabling for back up supply to CCTV System and Biometric Access System including laying out of all cables, conduit, power socket, labour and accessories required	Nos.	01			
12	Supplying and Drawing 3x 1.5 sq mm sizes of PVC insulated Copper Conductor, Single Core Cable in the existing surface/ recessed steel/ PVC Conduit as required.	Mtr	As required			
13	Supplying and Fixing of 25 sizes of medium class PVC Conduit alongwith accessories in surface/recess including cutting the wall and making good the same in case of recessed conduit as required.	Mtr	As required			
14	Supply & Laying of standardized 40 mm HDPE Pipe (Medium) inside the soft soil in depth of approx. 75 cm including Bends, Inspection Box	Mtr	As required			

Ser	Product Description	Unit	Qty	Warranty (Months)	Rate per Unit	Total Cost (Rate x Qty) (US\$/MMK)
(1)	(2)	(3)	(4)	(5)	(6)	(7)
	and all other material required to complete.					
15	Pole 5/9 meter Galvanized Pole	Nos.	As required			
16	Trenching	Mtr	As required			
17	Junction Box	Nos	As required			
18	Annual Maintenance Contract (Till 31 Oct 2026 from the date of completion of warranty period)					
19	Any other Material/Equipment/ accessories and Specification thereof		As required			
(a)						
(b)						
(c)						
(d)						
22	Any other charges					

Total in figure:

Total in Words :

Note:

1. The Financial Bid shall not include any conditions attached to it and any such conditional financial proposal shall be rejected summarily. The total quoted price should include all travel cost, shipping charges and other administrative cost, if any, that may be incurred by the vendor as part of this project.
2. The total cost for each items should be clearly mention. Price quoted only on rate per unit basis will not be accepted.
3. Separate sheets may be attached wherever necessary.

(Seal & Signature of the authorised Company Representative)
Name & Address: